

WS4938 Wireless Panic Button

Operating Instructions

Introduction

The WS4938 Wireless Panic Button was designed to transmit an emergency signal from any location within the range of the alarm system, regardless if the system is armed or disarmed.

The button is small and lightweight enough to be placed in a shirt pocket or tucked away inside a purse. It can also be used with the supplied neck strap or multi-functional clip - which can connect to your belt, car visor or be permanently mounted to a convenient location.

To activate, press and hold the button for approximately 2 seconds. The LED located on the top of the unit will light up to confirm a signal has been sent.

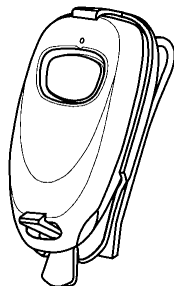

NOTE: Signals will not be received if the button is not within range of the wireless receiver.

Activating, Enrolling and Programming

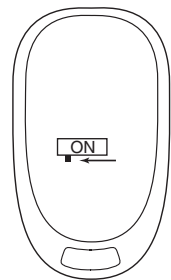

To conserve battery power the button comes deactivated. To activate simply remove the cover and slide the switch to the ON position (to the left).

This device is supervised. If the unit is removed from the coverage range a trouble will be indicated on the system. If this is not desired, the supervisory bit for this zone can be disabled on the receiver.

NOTE: For UL Listed installations, the supervisory bit in the receiver must be enabled.

The following outlines the basic steps for programming and enrolling this device on PowerSeries receivers.

For additional options or for other receivers please refer to the specific receiver installation manuals.

Step 1 - Program Electronic Serial Number (ESN)

Section [804], subsections [01] - [32]

[01] Zone 1 ... [32] Zone 32

Enter the 6 digit ESN located on the back of the device into the next available zone slot.

Step 2 - Program Zone Definition

Section [001] - [004]

Define the selected zone number with appropriate zone type [e.g., 24hr Panic (16), 24hr Holdup (12), 24hr Medical (15)]

Step 3 - Enable Wireless Zone Attribute

Section [101] - [132]

Turn Option [8] ON (wireless zone attribute) in corresponding zone attribute section

Step 4 - Enable/Disable Supervision (default is enabled)

Section [804], subsections [82] - [85]

[82] Wireless Zone Supervision (Zones 1- 8)

Default = ON

	OPTION ON	OPTION OFF
<input type="checkbox"/> Option 1	Zone 01 Supervision Enabled	Disabled
:	:	:
<input type="checkbox"/> Option 8	Zone 08 Supervision Enabled	Disabled

[83] Wireless Zone Supervision (Zones 9-16)

[84] Wireless Zone Supervision (Zones 17-24)

[85] Wireless Zone Supervision (Zones 25-32)

Compatibility

The WS4938 is compatible with the following receivers:

- PC4164-433 (v3.00 or greater)
- PC5132-433 (v4.2X or greater)
- RF5501-433
- RF5108-433
- NT9005

Replacing the Batteries

Under normal conditions the batteries can last up to 2 years. If the battery is low, the trouble light on the keypad will turn ON.

To replace the batteries, remove the top cover by inserting a coin into the slot located on the bottom right corner and twist. Remove the screw at the center of the board to expose the batteries. Replace both batteries with Panasonic CR-2025 lithium batteries (see diagram).

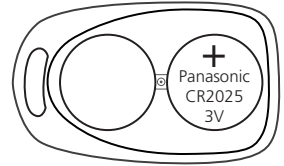

The NT9005 v1.02 requires that the serial number of the WS4938 be deleted and re-enrolled in order to restore the low battery.

NOTE: The polarity of the battery must be observed, as shown in the diagram above. Improper handling of lithium batteries may result in heat generation, explosion or fire, which may lead to personal injuries.

WARNING: Danger of explosion if batteries are installed incorrectly. Replace only with the same or equivalent type recommended by the manufacturer. Keep away from small children. If Batteries are swallowed, promptly see a doctor. Do not try to recharge these batteries. Disposal of used batteries must be made in accordance with the waste recovery and recycling regulations in your area.

Belt Clip Assembly and Mounting

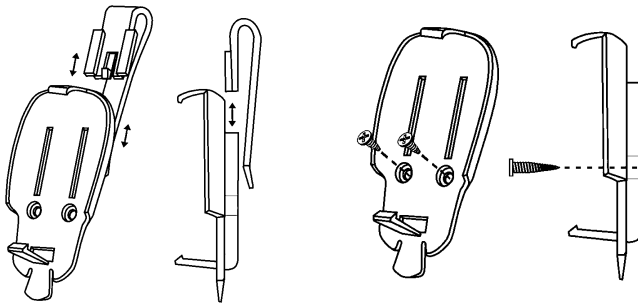

Specifications

- 32°to 120°F (0°-49°C)
- 5-93% RH
- Water Resistant

FCC COMPLIANCE STATEMENT

This device complies with Part 15 of the FCC Rules. Operation is subject to the following two conditions: (1) This device may not cause harmful interference, and (2) this device must accept any interference received, including interference that may cause undesired operation.

IC: 160A-WS4938 The term 'IC:' before the radio certification number only signifies that Industry Canada technical specifications were met.

UL and ULC Listed.



DSC™

©2005 Digital Security Controls, Toronto, Canada
Technical Support: 1-800-387-3630 • www.dsc.com
Printed in Taiwan